



# UPON YOUTH SHARING COMMUNITY

---

Client	Tianjin Binhai Tourism Holding Co Ltd
Services	Interior Design
Type	Cultural Building
Location	Binhai New District, Tianjin
Area	4000sqm
Time	2016

UPON YOUTH SHARING COMMUNITY is located at Sino-Singapore Eco City, Haibo Road, Binhai New District, Tianjin, with a total investment of 6 million Yuan. The total renovation construction area is 4000 square meters and the total GFA is about 13,000 square meters. With the people-oriented and comprehensive design concept that respects environment, space, culture and efficiency, we aim to create a unique housekeeper eco system for entrepreneurs, a regional integrated youth community, a comprehensive financial service platform, an industrial real-estate service platform and a cultural industrial service platform, to develop the economy of the youth community, to provide perfect entrepreneurial, rental and living experience for tenants, and to promote the network development, intelligent development, service-oriented and coordinated development in the youth community.



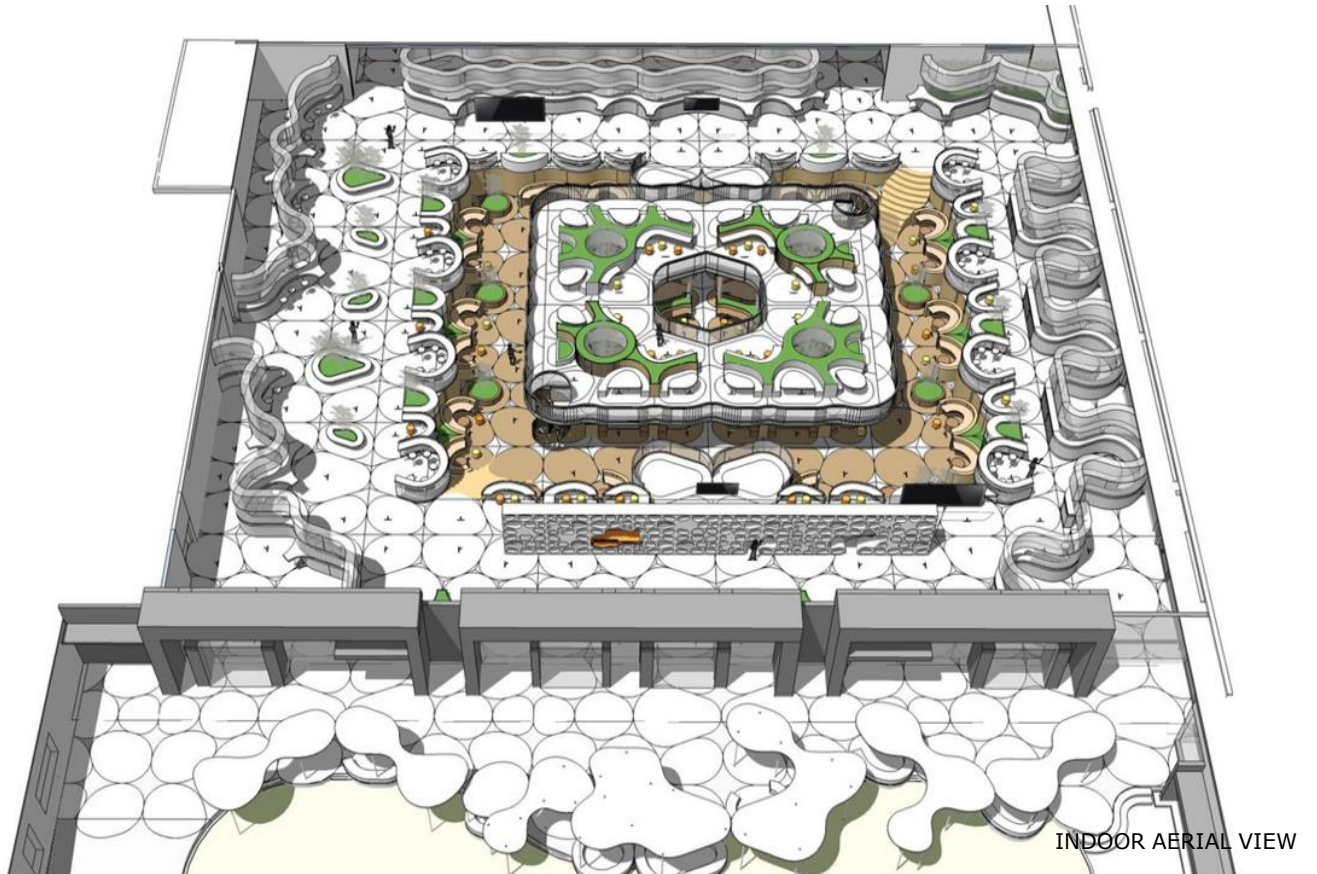

水细胞元素  
WATER CELL



泰森多边形网络  
THIESSEN POLYGON

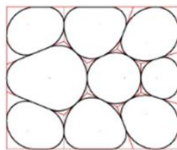

参数模块  
PARAMETRIC MODULE

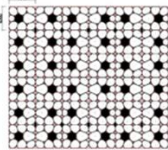

脉络肌理  
TEXTURE

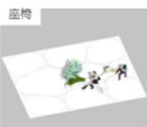
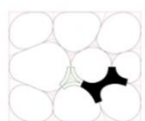

座椅

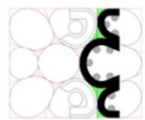

卡座

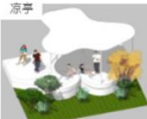
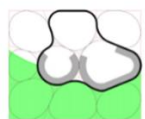

凉亭

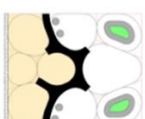

吧台



组合

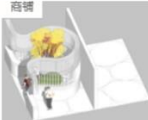
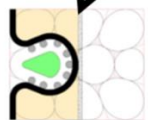

商铺

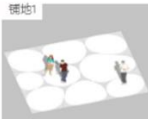

铺地1

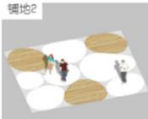

铺地2

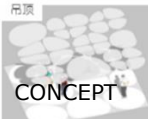

吊顶

多种功能形式

VARIETY OF  
FUNCTIONS

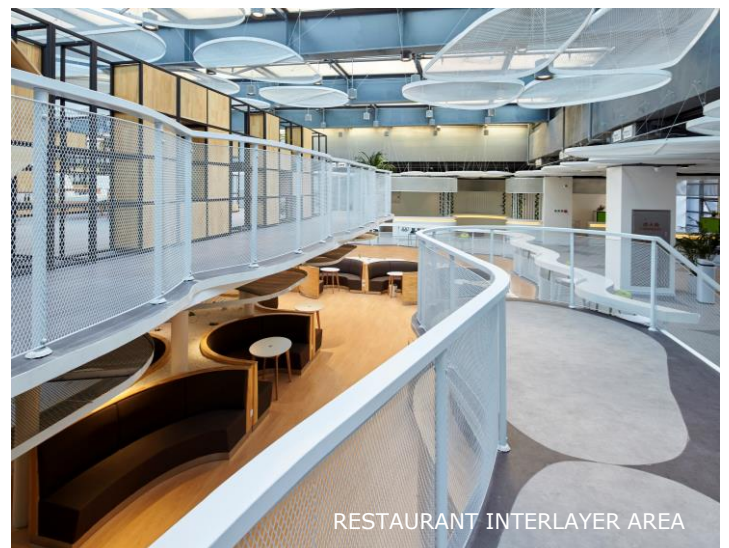





BOOK BAR/SERVICE ISLAND

STRUCTURE OF PATTERN

"MODUL"

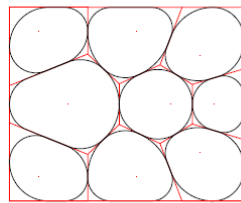
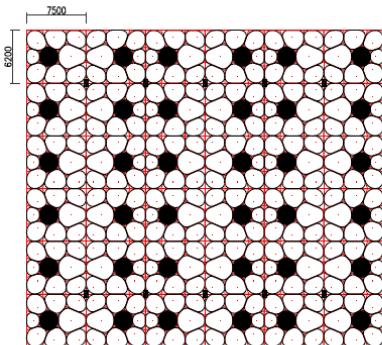

CREATE CELL MODUL IN THE POOL AREA WHICH WILL BECOME TO FLOOR PAVING, FURNITURE, WORK STATION, LIGHTING, LANDSCAPE, ETC...

CONCEPT

We extract water elements from the memory of the original swimming pool. Through parameterization design, a leaf vein network of thiesen polygon has been formed, organically connecting different areas and various functions. There are multiple companies in the shared area providing diversified supporting services in order to facilitate the work, living and entertainment needs of apartment residents and company staff, to give youth a unique space to live and start up business and to attract more industry population. The office area is equipped with companies providing enterprise services to realize the integration of commerce, industry, internet and incubation for each project in the space. Taking this as the feature and purpose of the project, the transferability and replicability can be successfully achieved.



SERVICE AREA

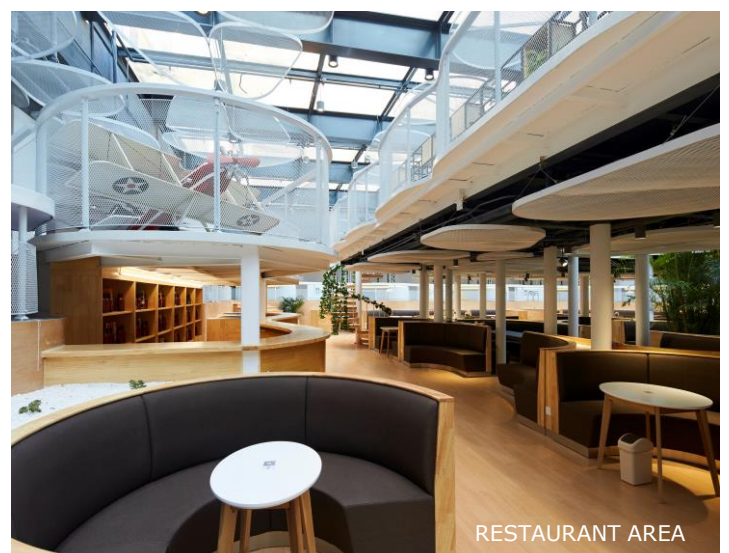

RESTAURANT AREA



